

BATHTUB INSTALLATION SYSTEM

Edition : 2020



Nea Ionia 14-16,
7101 Aradippou Industrial Zone
P.C 42068, 6530-Larnaca,
Tel: 70003553, +357 24813481, Fax: +357
24813479

www.bautech.com.cy

BATHTUB INSTALLATION SYSTEM

1) Without support set and
perimeter base

Step 1) Pour 2-3 containers of thick cement mortar at the point where you want to place the bathtub, carefully not to let it penetrate the point where you will connect the shower waste.

Step 2) Place the bathtub on the cement mortar, level it, and connect the drain and overflow valve .

Step 3) In cases where the bathtub comes with legs, the bathtub is installed together with the side panel and after the floor tiles have been laid so that the side panel can rest on top.

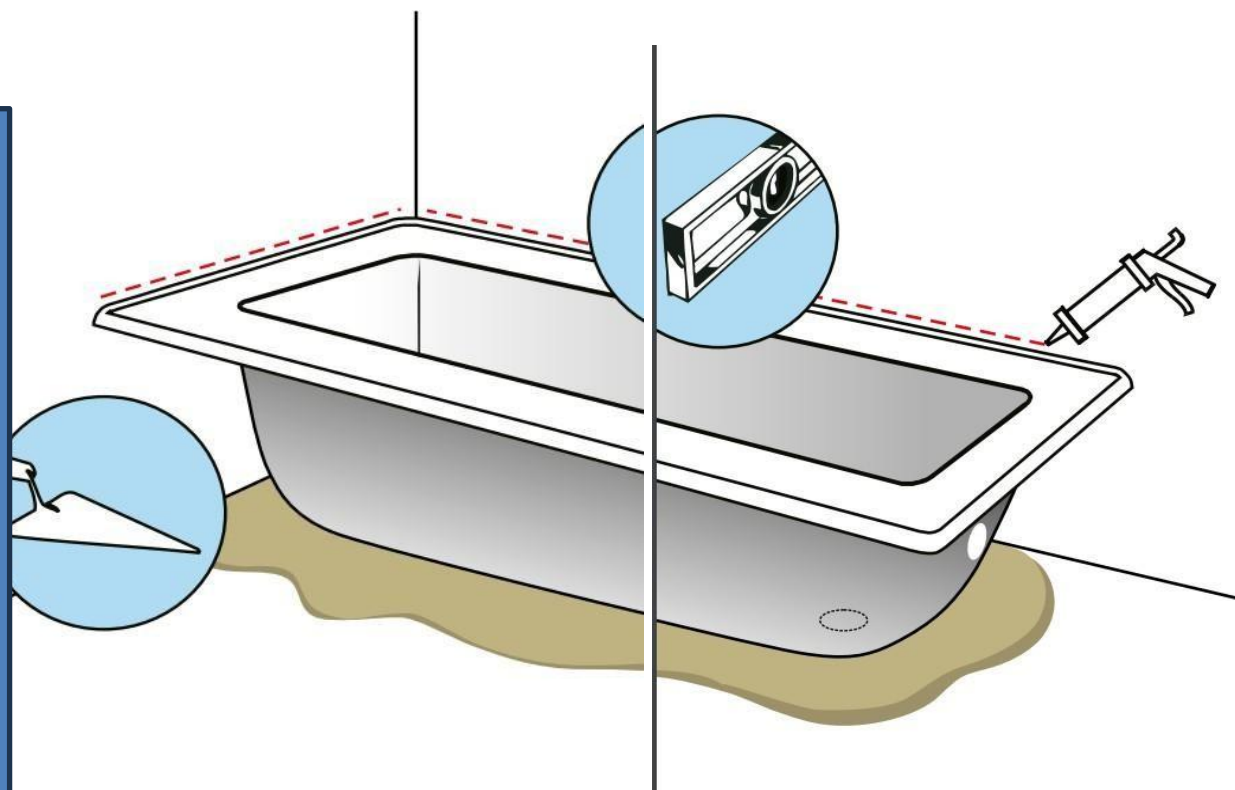

At the point where the tiles meet the bathtub, seal with OTTOCHEMIE OTTOSEAL S100 anti-mould silicone sealant (available in various colors) using OTTOCHEMIE OTTOPRIMER X-PR 1216 250ml primer. OTTOCHEMIE OTTO-FUGENBOY Y-ZUB grouting trowels and OTTOCHEMIE OTTO SMOOTHING X-GL liquid abrasive for easier and cleaner silicone application (see installation system).

2) With support set

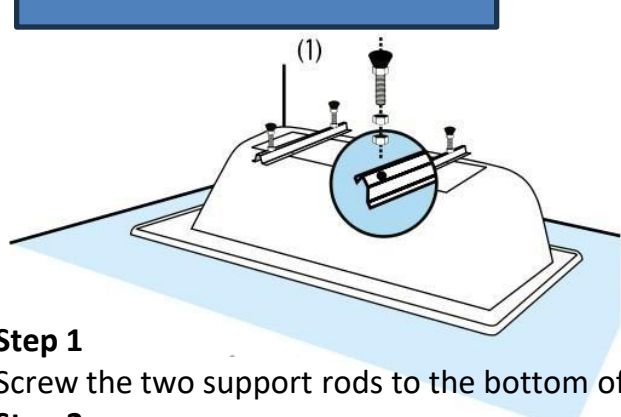

Step 1

Screw the two support rods to the bottom of the bathtub and place the plastic height adjustment feet in the openings (diagram 1).

Step 2

Place the bathtub in the installation location, determine the height, and level it by adjusting the regulators to the appropriate height .

Step 3

If the bathtub comes with a side and panel , adjust the height of the bathtub based on the height of the panels by temporarily placing it on the bathtub and checking the fit .

Step 4

Mark the outline of the bottom edge of the bathtub on the wall, based on that we place the wall support corners. (drawing 2)

Step 5

Place the bathtub on the wall support corners and connect the drain and overflow valve (drawing 3).

Step 6

If the bathtub comes with a panel , attach it to the special sockets by screwing it to the corners on the right and left. (diagram 4)

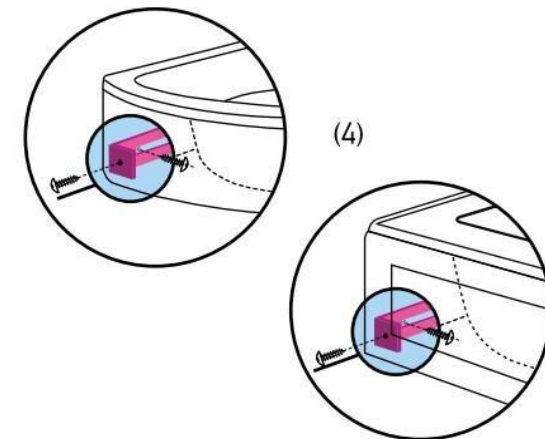
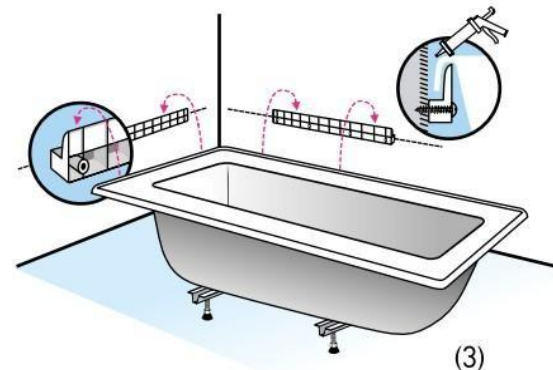
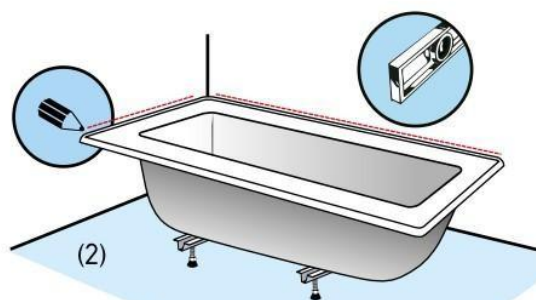

In any case, cement mortar or polyurethane foam should be placed between the bathtub and the floor (if polyurethane foam is used, the bathtub must be filled with water so that it does not move due to the force exerted by the polyurethane foam .

At the point where the tiles meet the bathtub, we use silicone or grout for better waterproofing.

3)With a Perimetric Base Support

Step 1) We apply the bathtub to the installation point, level it and connect the overflow and drain valve (optionally, for greater stability of the bathtub, we can screw the plastic feet to the floor)

Step 2) In cases where the bathtub is accompanied by legs, the height of the bathtub has been adjusted based on the height of the panels and all that remains is to apply the panels to the special slots by screwing it onto the corners of the perimetric base.

Step 3) In cases where the bathtub does not come with legs, the desired height is achieved by adjusting the regulators of the perimetric base

In any case, cement mortar or polyurethane foam should be placed between the bathtub and the floor (if we use polyurethane foam, the bathtub must be filled with water so that it does not move due to the force exerted by the polyurethane foam).

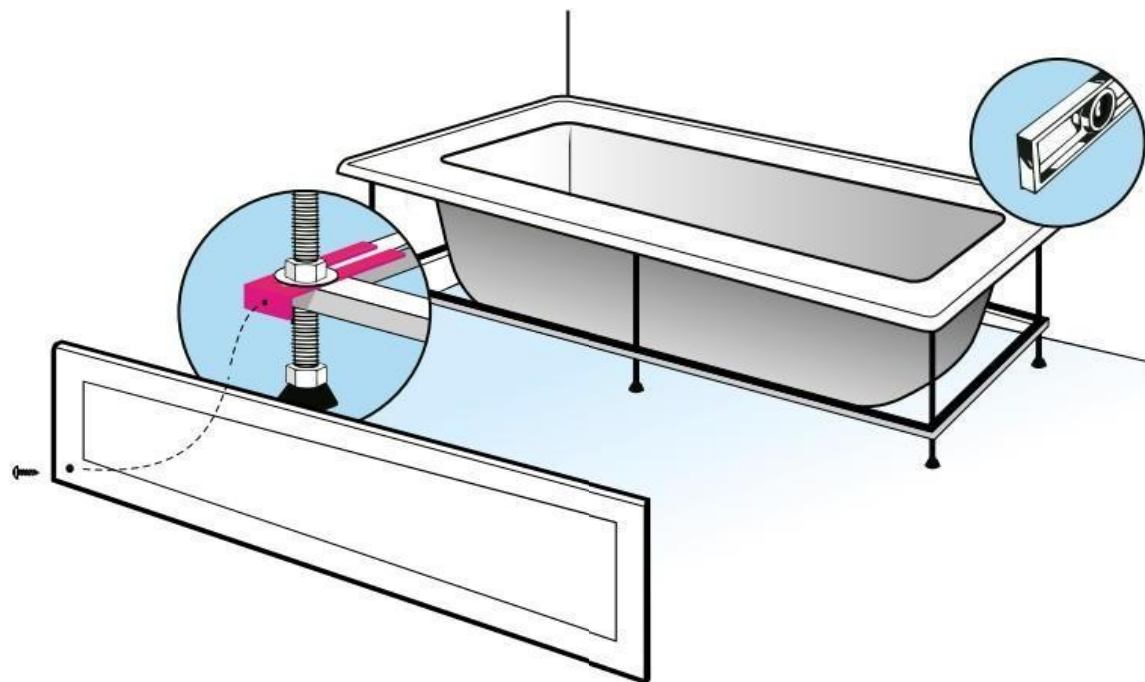

At the point where the tiles join the bathtub, we seal with **OTTOSEAL S100** anti-mold silicone sealant by **OTTOCHEMIE** (available in various colors) using the OTTOPRIMER X-PR 1216 250ml primer by OTTOCHEMIE, the OTTO-FUGENBOY Y-ZUB spatulas for forming grout by **OTTOCHEMIE** and the **OTTO SMOOTHING X-GL** liquid-abrasive by **OTTOCHEMIE** for easier and cleaner shaping of the silicone, (see installation system)